

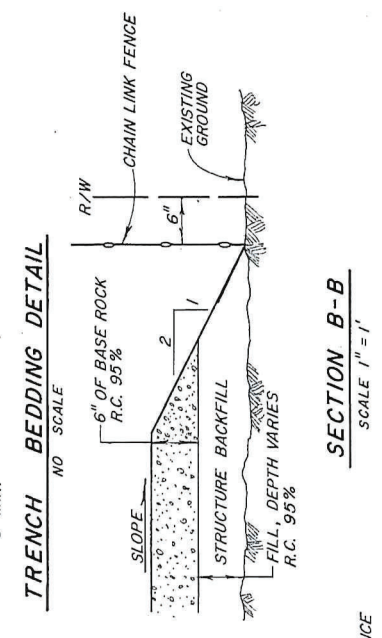

By	RUSSIAN RIVER - COTATI INTERTIE PROJECT
Scale	AS SHOWN
Date	19 MAY 1983
Approved	CHIEF ENGINEER
Drawn	gdt
Checked	
Designed	R.C.E. 20/81
Submitted	60-3-102.8
SONOMA COUNTY WATER AGENCY	

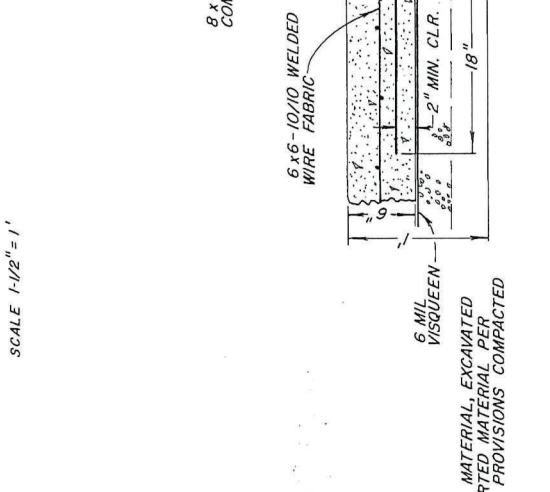
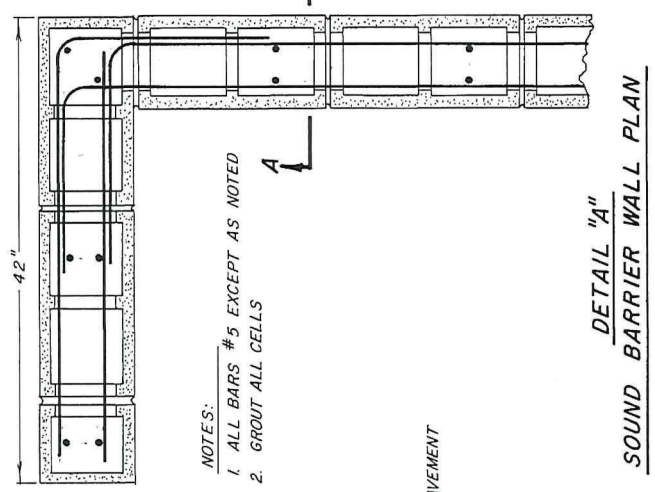
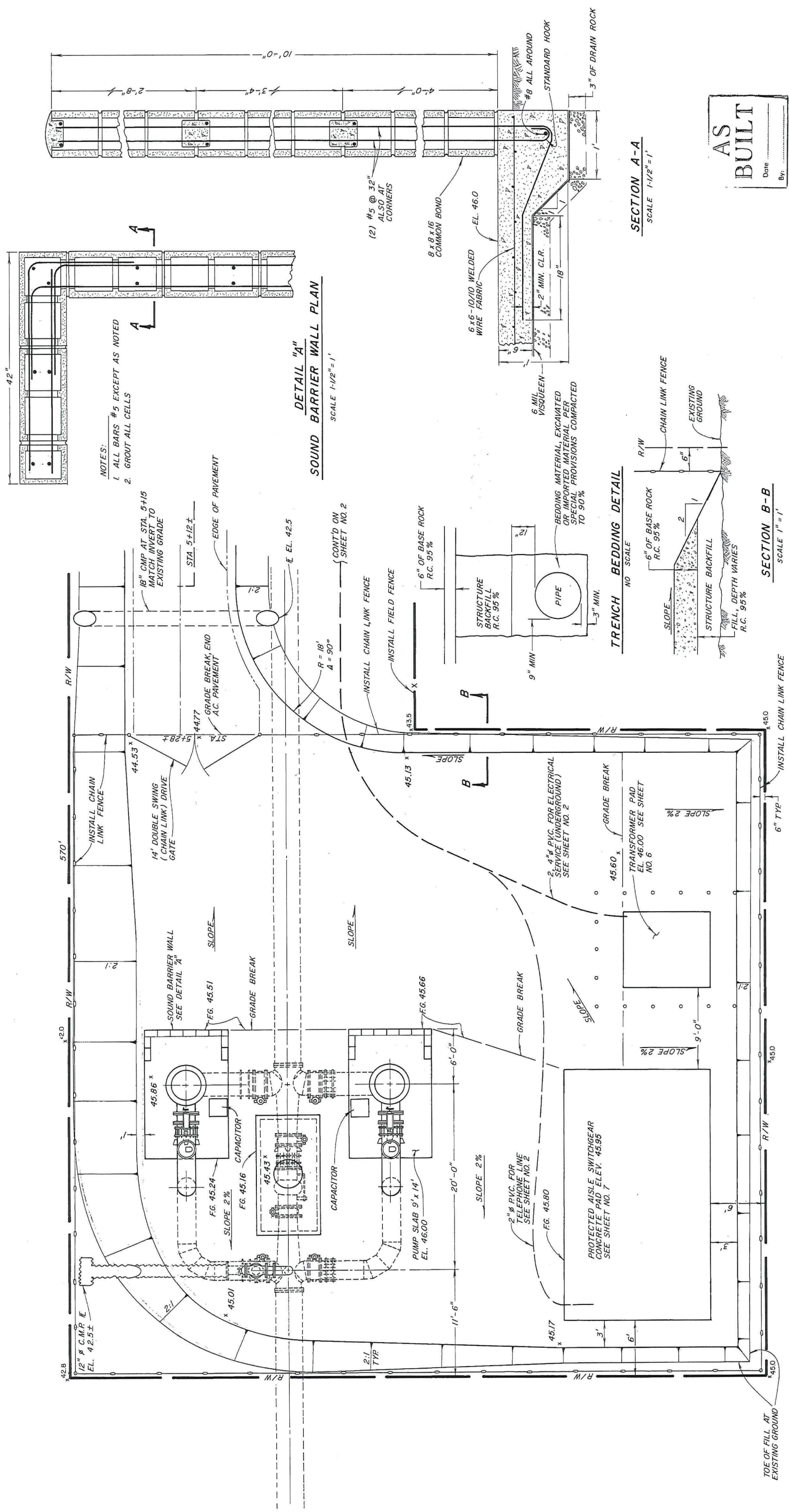

**SITE PLAN**  
 SCALE 1" = 5'

**AS BUILT**  
 Date: \_\_\_\_\_  
 By: \_\_\_\_\_



# SWGR AND GENERATOR PLAN

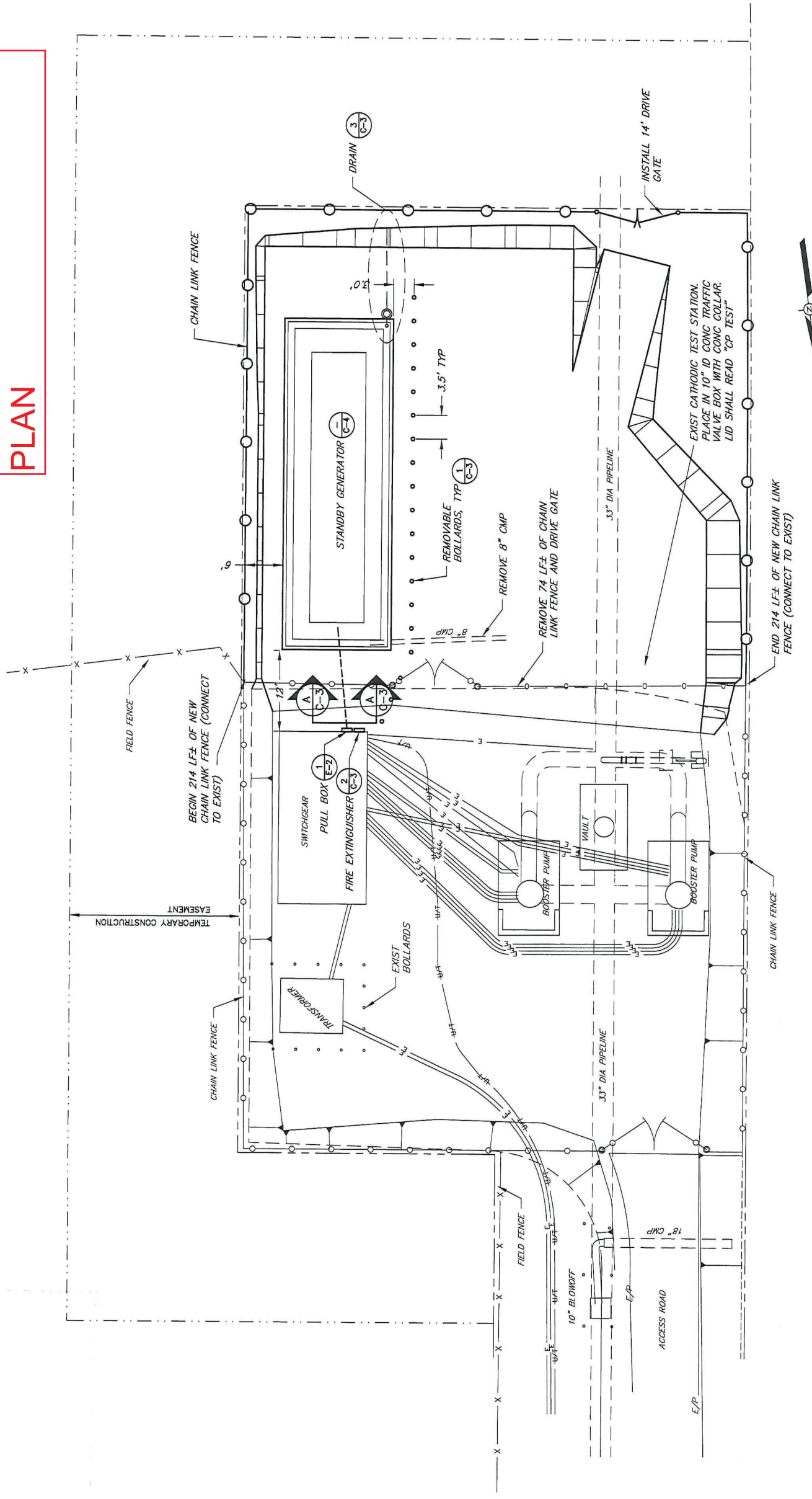

PLAN

**RECORD DRAWING**  
DATE: 2/22/05



BAR LENGTH ON ORIGINAL DRAWING SHALL BE IN INCH. ADJUST SCALE ACCORDINGLY.



NO.	DATE	REVISION
A	2/22/05	RECORD DRAWING
	01/15/05	CONFORMED

SCALE: AS SHOWN	APPROVED: DEPUTY CHIEF ENGINEER	RCE C54302
DATE: 14 SEPT 2004	SUBMITTED	RCE C4882
DRAWN: ADF	DESIGNED	RCE C4882
CHECKED:		RCE C4882

**ELY BOOSTER PUMP STATION  
STANDBY GENERATOR  
SITE PLAN**

FILE NAME: 3836-COIR  
CONTRACT NUMBER: 80-3-7 #14

DRAWING NUMBER: C-1

SHEET 3 OF 11

BARY

# GENERATOR BASE

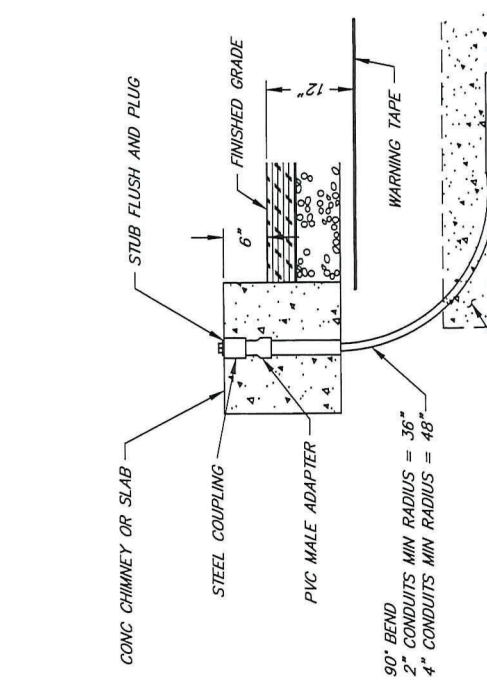
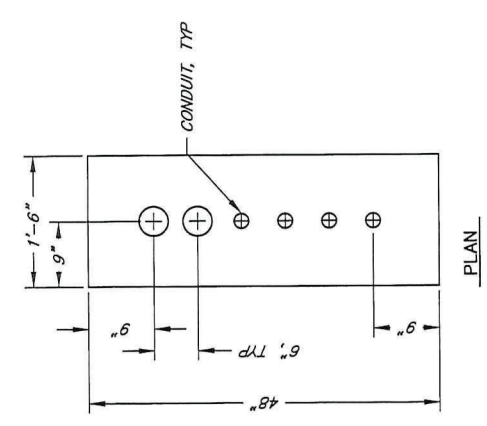

1 1  
- E-2

TYPICAL ELECTRICAL CONDUIT STUB-UP CHIMNEY DETAIL  
SCALE: 1" = 1'

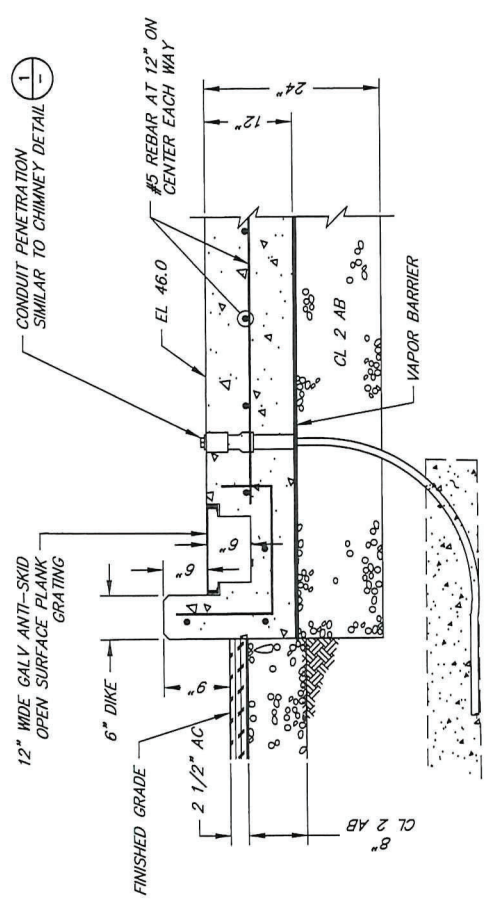

A

- NOTES:
- FOR CONDUITS TERMINATED IN AN ENCLOSURE INSTALL TWO SEALING LOCKNUTS & A BONDING BUSHING.
  - ALLOW CLEARANCE FOR COMPRESSION NUT ON EACH CONDUIT.
  - REFER TO DRAWING E-1 FOR GROUNDING DETAILS.

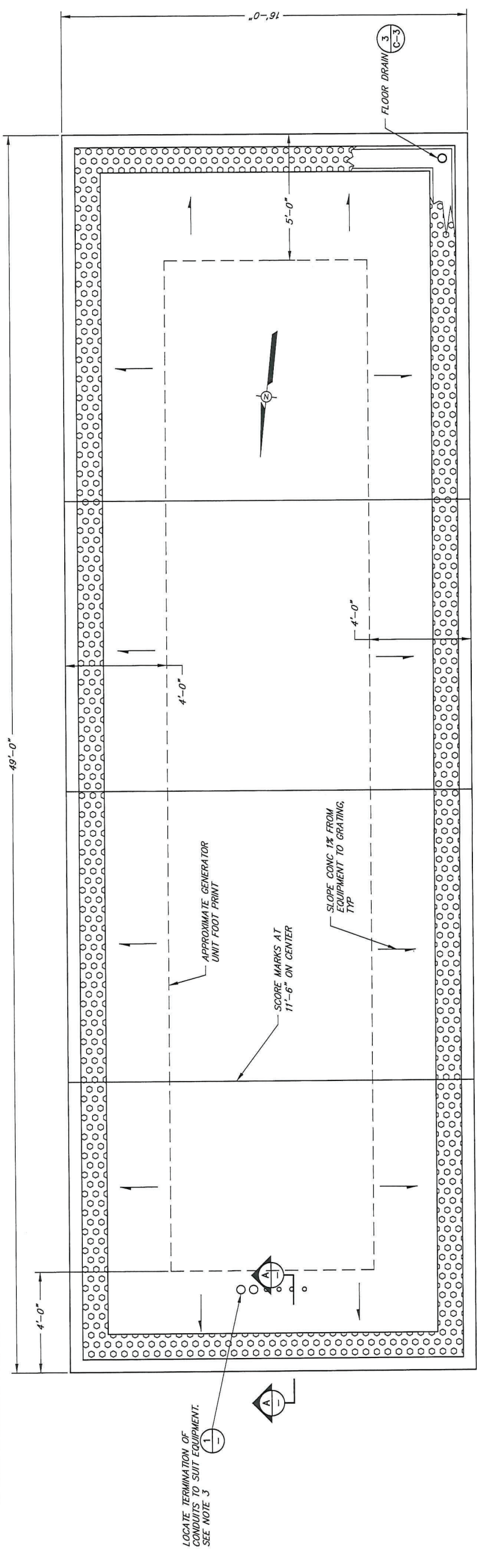

**RECORD DRAWING**  
DATE: 2/22/05

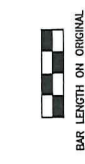

APPROVED	DEPUTY CHIEF ENGINEER	SCALE	AS SHOWN
SUBMITTED	DATE: 14 SEPT 2004	DATE	14 SEPT 2004
DESIGNED	DRAWN: ADF	DESIGNED	DATE: 14 SEPT 2004
CHECKED:		CHECKED:	

ELY BOOSTER PUMP STATION  
STANDBY GENERATOR  
GENERATOR PAD DETAILS

DRAWING NUMBER: C-4  
SHEET 6 OF 11

FILE NAME: 3836-C04R  
CONTRACT NUMBER: 60-3-7 #14

RCE C54302  
RCE C46602  
RCE C46602

NO. DATE

REVISION

BY

NO. DATE

REVISION

BY

# GENERATOR DETAILS

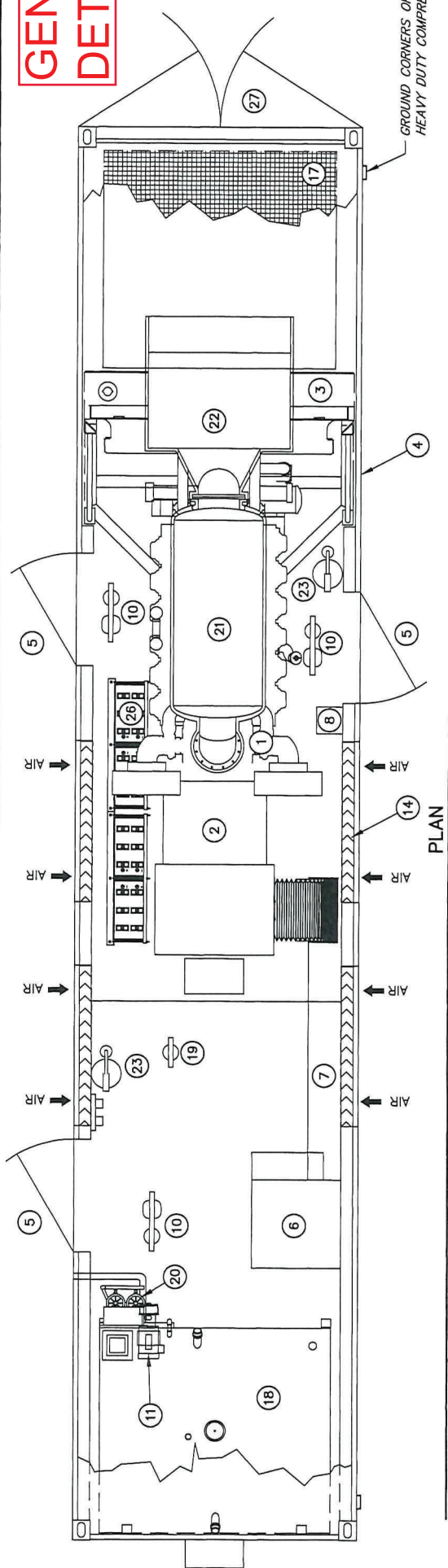

PLAN

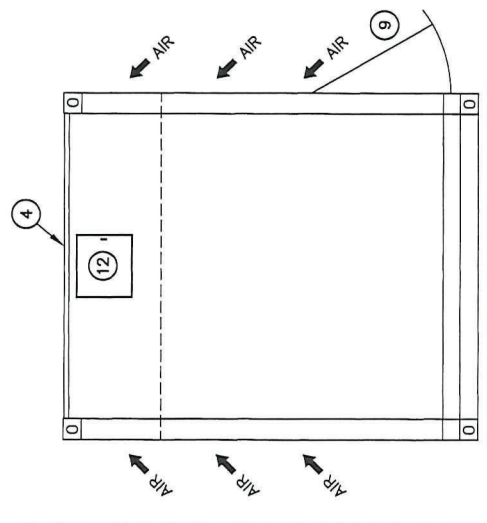

ELEVATIONS

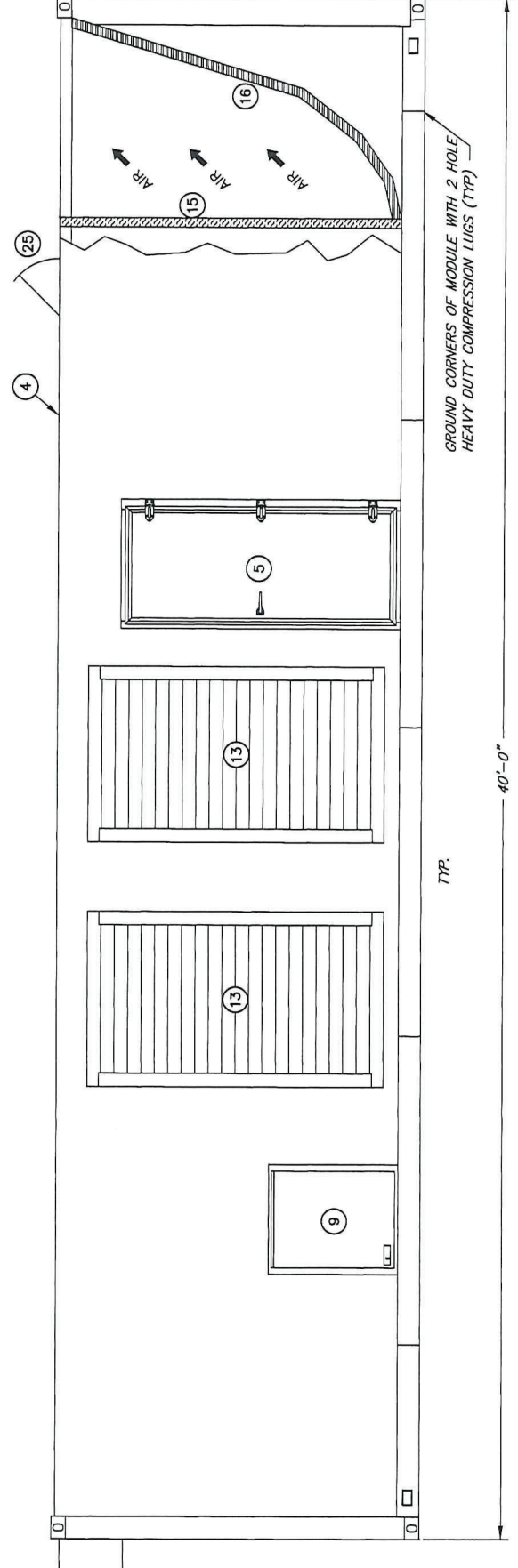

ELEVATIONS

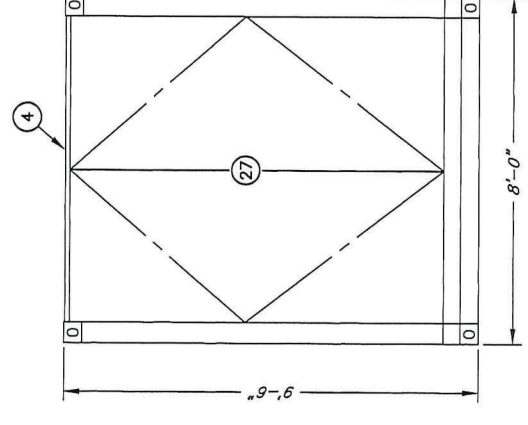

ELEVATIONS

### PARTS LIST

ITEM QTY	DESCRIPTION	ITEM QTY	DESCRIPTION
1	ENGINE	21	EXHAUST SILENCER
1	GENERATOR RATED 1500 KW, 3 PH., 60 HZ., 4160 VOLT	22	EXHAUST DISCHARGE BOX
1	FUEL PUMP	23	FIRE EXTINGUISHER
2	EXTERIOR FUEL FILL DOOR	24	MOBILE EQUIPMENT SPRING TYPE VIBRATION ISOLATOR (NOT SHOWN)
4	FIXED OPEN SOUND ATTENUATING AIR INTAKE LOUVER	25	RADIATOR FILL ACCESS DOOR
4	AIR INTAKE SILENCER	26	BATTERY SET
3	36" x 80" PERSONNEL DOOR	27	ORIGINAL CONTAINER DOOR SET
1	40' LONG CUBE 1 SQ SHIPPING CONTAINER LINED W/ 4" SOUND WALLS		
1	RADIATOR		
1	FLOOR STANDING CIRCUIT BREAKER & CONTROL PANEL		
1	FLOOR MOUNTED CABLE TRAY		
2	SHORE POWER RECEPTACLES		
1	LOAD CABLE CONNECTION ACCESS DOOR		
1	2000 GALLON FUEL TANK		
1	24 VOLT DC LIGHTS		
1	FUEL/WATER SEPARATOR		
1	(3) 120 VAC LIGHTS IN VAPOR TIGHT FIXTURES WIRED TO SWITCH LOCATED NEAR CURB SIDE PERSONNEL DOOR & (2) 24 VDC LIGHTS IN VAPOR TIGHT FIXTURES WIRED TO 60 MINUTE TIMER		

**RECORD DRAWING**  
DATE: 2/22/05

APPROVED: DEPUTY CHIEF ENGINEER  
RCE C54302  
SUBMITTED: REE 10180  
DESIGNED: REE 17078

ELY BOOSTER PUMP STATION  
STANDBY GENERATOR  
STANDBY GENERATOR LAYOUT AND DETAILS

SCALE: NONE  
DATE: 13 SEPT 2004  
DRAWN: ADF  
CHECKED:

FILE NAME: 3836-EDR  
CONTRACT NUMBER: 60-3-7 #14  
DRAWING NUMBER: E-1  
SHEET 7 OF 11

NO. DATE REVISION BY

A	2/22/05	RECORD DRAWING	BY
	01/13/05	CONFORMED	

BAR LENGTH ON ORIGINAL DRAWING EQUALS ONE INCH, ADJUST SCALE ACCORDINGLY